

8 PROJECTS UDERTAKEN AND CURRICULUM VITAE

8.1 Office and Commercial Blocks



Project:	Proposed Ministry of Animal Resources Headquarters
Client:	Government of South-Sudan
Value:	US\$ 30,000,000.00 (Approx)
Date:	December 2010
Location:	Juba - South Sudan
Scope:	5-Storey Office Block: 20,200M ²

Project Manager:	Sunya Development
Architect:	Sunya Development
Quantity Surveyor:	Sunya Development
Electrical Engineer:	Sunya Development
Mechanical Engineer:	Sunya Development
Structural Engineer:	Sunya Development

Project:	Proposed Business Centre
Client:	Juba Business Group
Value:	US\$ 15,000,000.00 (Approx)
Date:	November 2011
Location:	Juba - South Sudan
Status:	Concept Design
Consultant:	Sunya Development



Project:	Proposed Refurbishment at Ministry of Education
Client:	Ministry of Infrastructure
Value:	US\$ 3,000,000.00 (Approx)
Date:	May 2011
Location:	Kigali - Rwanda
Scope:	Refurbishment of the Entire 6 Storey Building
Status:	Tender Documentation Completed
Project Manager:	Landmark Ltd
Architect:	Landmark Ltd
Quantity Surveyor:	Sunya Development
Electrical Engineer:	Sunya Development
Mechanical Engineer:	Sunya Development
Structural Engineer:	Sunya Development



Project:	Proposed Refurbishment at Ministry of Infrastructure Offices
Client:	Ministry of Infrastructure
Value:	US\$ 3,500,000.00 (Approx)
Date:	May 2011
Location:	Kigali - Rwanda
Scope:	Refurbishment of the Entire 7 Floors Building
Status:	Phase I at Tender Process
Project Manager:	Archinnova / TRIAD Architects
Architect:	Landmark Ltd
Quantity Surveyor:	Ooro & Sanya / Sunya Development



Project:	Proposed Amarembo Centre
Client:	Amarembo
Value:	US\$ 35,000,000.00 (Approx)
Date:	October 2011
Location:	Kigali - Rwanda
Scope:	Commercial Centre with 9 Blocks of Offices, Hotels, Shopping Malls
Status:	Preliminary Design & Estimates
Project Manager:	CAIR
Architect:	CAIR
Quantity Surveyor:	Sunya Development
Electrical Engineer:	Sunya Development
Mechanical Engineer:	Sunya Development



Project:	Proposed Westgate Business Park
Client:	COCOMANYA
Value:	US\$ To be Determined (Approx)
Date:	November 2011
Location:	Kigali - Rwanda
Scope:	Commercial Business Complex
Status:	Preliminary Design
Project Manager:	CAIR
Architect:	CAIR
Quantity Surveyor:	Sunya Development
Electrical Engineer:	Sunya Development
Mechanical Engineer:	Sunya Development



Project:	Proposed Offices in Nyarugenge
Client:	R. Longin
Value:	US\$ 10,500,000.00 (Approx)
Date:	May 2011
Location:	Kigali - Rwanda
Scope:	Refurbishment of the Entire 6 Storey Building
Status:	Preliminary Designs



Project:	Proposed Sunya Plaza
Value:	US\$ 2,100,000.00 (Approx)
Date:	October 2008
Location:	Juba - South Sudan
Scope:	Commercial Centre with Offices and Shops



Project:	Proposed Business Centre
Client:	Ankip
Value:	US\$ 600,000.00 (Approx)
Date:	October 2010
Location:	Juba- South Sudan
Status:	Up to Preliminary Design



Project:	Proposed Commercial Block
Client:	Bros & Company
Value:	US\$ 700,000.00 (Approx)
Date:	June 2007
Location:	Kaya - South Sudan
Consultant:	Sunya Development

8.2 Hotel Projects



Project:	Proposed Gumbo Resort Hotel
Client:	C. Swaka
Value:	US\$ 5,000,000.00 (Approx)
Date:	November 2011
Location:	Juba - South Sudan
Scope:	45-bed Hotel with Kitchen, Business Centre, Administration
Status:	Design On-going



Project Manager:	Sunya Development
Architect:	Sunya Development
Quantity Surveyor:	Sunya Development
Electrical Engineer:	Sunya Development
Mechanical Engineer:	Sunya Development
Structural Engineer:	Sunya Development



Project:	Proposed Camp in Juba
Client:	L. Mos
Value:	US\$ 830,000.00 (Approx)
Date:	July 2008
Location:	Juba - South Sudan
Status:	Completed
Consultant:	Sunya Development



Project:	Proposed Safari Hotel
Client:	Safari Hotel
Value:	US\$ 2,000,000.00 (Approx)
Date:	October 2011
Location:	Kigali - Rwanda
Scope:	60-bed Hotel
Status:	Design On-going



Project:	Proposed Rushell Guest House
Client:	Nyramilimo Odette
Value:	US\$ To be determined (Approx)
Date:	November 2011
Location:	Kigali - Rwanda
Scope:	Hotel with Swimming Pool, Restaurant, rooms, Jacuzzi, Spa
Status:	Design and Documentation



Architect:	Landmark Ltd / Robert Fieldler Architecture Inc (Toronto)
------------	---



8.3 Institutions Projects



Project:	Proposed Kampala International University Kitengela Campus
Client:	Kampala International University
Value:	US\$ 6,500,000.00 (Approx)
Date:	December 2010
Location:	Kitengela-Kenya
Scope:	Campus with Administration Block, Health Centre, Lecture Theatres, Hostels, Kitchen, Dinning Hall, Library
Status:	Construction On-going
Project Manager:	Sunya Development
Architect:	Sunya Development
Quantity Surveyor:	Sunya Development
Mechanical Engineer:	Sunya Development

Project:	Proposed Gashora Girls Academy	
Client:	Rwanda Girls Initiative	Architect: Landmark Ltd
Value:	US\$ 1,600,000.00 (Approx)	Quantity Surveyor: Sunya Development
Date:	October 2010	Structural Engineer: EDDYS
Location:	Bugesera - Rwanda	Status: Completed February 2011
Scope:	Girls School with Laboratories, Classrooms, Dormitories, Hall, Kitchen, Community Centre	Project Manager: Landmark Ltd

Project:	Proposed PSO Training Centre in Gishari		
Client:	GIZ / Rwanda National Police	Architect:	Landmark Ltd
Value:	US\$ 3,300,000.00 (Approx)	Quantity Surveyor:	Sunya Development
Date:	October 2010	Electrical Engineer:	Sunya Development
Location:	Kigali - Rwanda	Mechanical Engineer:	Sunya Development
Scope:	Training Centre with Administration Blocks, Residential Quarters, Dormitories, Classrooms and Multi-purpose Hall	Structural Engineer:	Sunya Development
		Status:	Phase I Construction On-going

Project:	Proposed Printery for Rwanda National Examination Council		
Client:	Rwanda National Examination Council	Architect:	Landmark Ltd
Value:	US\$ 1,500,000.00 (Approx)	Quantity Surveyor:	Sunya Development
Date:	March 2011	Electro - Mechanical Engineer:	Sunya Development
Location:	Kigali - Rwanda	Status:	Tender Documentation Completed
Scope:	Conversion of Warehouse into a National Printery	Project Manager:	Landmark Ltd



Project:	Proposed ICT Centre at Juba University		
Client:	Juba University		
Status:	Upto Concept Design		
Date:	July 2011		
Location:	Juba - South Sudan		

8.4 Housing Projects



Project:	Proposed Mountainview Estate
Client:	Region Holdings Ltd
Value:	US\$ 2,500,000.00 (Approx)
Date:	August 2010
Location:	Kigali - Rwanda
Scope:	20 No. 4-bedroomed Massionates
Status:	Construction On-going



Project Manager:	Region Holdings Ltd
Architect:	CAIR
Quantity Surveyor:	Sunya Development
Electrical Engineer:	Sunya Development
Mechanical Engineer:	Sunya Development
Structural Engineer:	Sunya Development





Project:	Proposed Hamilton Apartments
Client:	Hamilton
Value:	US\$ 1,500,000.00 (Approx)
Date:	October 2011
Location:	Kigali - Rwanda
Scope:	16 No. Units Apartments
Status:	Design and Documentation
Architect:	Landmark Ltd



Quantity Surveyor:	Sunya Development
	



Project:	Proposed Governor's Residence
Client:	
Value:	US\$2,000,000.00 (Approx)
Date:	December 2010
Location:	Wau - South Sudan
Status:	Preliminary Drawings
Consultant:	Sunya Development

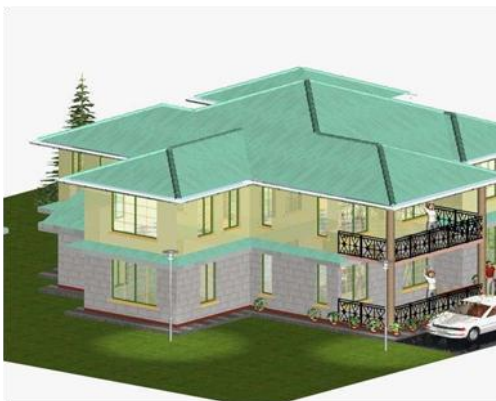

Project:	Proposed House
Client:	Colonel Mach
Value:	US\$ 300,000.00 (Approx)
Date:	July 2007
Location:	Juba - South Sudan
Status:	Construction
Consultant:	Sunya Development



Project:	Proposed Apartments
Client:	Ambassador Kimonyo
Value:	US\$ 800,000.00 (Approx)
Date:	August 2011
Location:	Kigali - Rwanda
Scope:	16 No. 4-bedroomed Apartments
Status:	Design On-going



Project:	Proposed Bungalow
Client:	Ministry House
Status:	Upto Design
Date:	October 2007
Location:	Juba - South Sudan

8.5 Sports Facilities Projects

Project:	Proposed Rehabilitation and Extension of Stadium Umuganda - Rubavu		
Client:	Ministry of Culture & Sports	Project Manager:	Roko Construction
Value:	US\$	Quantity Surveyor:	Sunya Development (Sub-consultant)
Date:	August 2010	Scope:	Conversion of Warehouse into a National Printery
Location:	Kigali - Rwanda	Status:	Completed



Project:	Proposed Gymnasium
Client:	Ankip
Value:	US\$ 1,000,000.00 (Approx)
Date:	August 2007
Location:	Juba- South Sudan
Status:	Up to Preliminary Design

8.6 Finance and Banking Institutions Projects



Project:	Proposed Branch Premises and Residential Quarters for KCB in Wau
Client:	KCB Sudan Ltd
Value:	US\$ 1,000,000.00 (Approx)
Date:	October 2007
Location:	Wau - South Sudan
Status:	Up to Tender
Consultant:	Sunya Development



Project:	Proposed Branch Premises for KCB in Yei
Client:	KCB Sudan Ltd
Value:	US\$ 450,000.00 (Approx)
Date:	May 2008
Location:	Yei - South Sudan
Status:	Completed December 2008
Consultant:	Sunya Development



Project:	Proposed Branch Premises for KCB in Bentiu
Client:	KCB Sudan Ltd
Value:	US\$ 350,000.00 (Approx)
Date:	June 2008
Location:	Bentiu - South Sudan
Status:	Completed April 2009
Consultant:	Sunya Development



Project:	Proposed Branch Premises for KCB in Wau
Client:	KCB Sudan Ltd
Value:	US\$ 800,000.00 (Approx)
Date:	June 2008
Location:	Wau - South Sudan
Status:	Completed April 2011
Consultant:	Sunya Development



Project:	Proposed Branch Premises for KCB in Wau
Client:	KCB Sudan Ltd
Value:	US\$ 500,000.00 (Approx)
Date:	June 2008
Location:	Wau - South Sudan
Status:	Completed March 2009
Consultant:	Sunya Development

Project:	Proposed Branch Premises for KCB in Rock city	Architect:	Sunya Development
Client:	KCB Sudan Ltd	Quantity Surveyor:	Sunya Development
Value:	US\$ 65,000.00 (Approx)	Electrical Engineer:	Sunya Development
Date:	April 2008	Mechanical Engineer:	Sunya Development
Location:	Juba - South Sudan	Structural Engineer:	Sunya Development
Status:	Completed July 2009	Scope:	Bank Premises Complete with Counters, Banking Hall and Strong room

Project:	Proposed Fit-out for KCB - African Queen Plaza	Architect:	Aventis Ltd
Client:	KCB Sudan Ltd	Quantity Surveyor:	Sunya Development
Value:	US\$ 1,000,000.00 (Approx)	Electrical Engineer:	Webston Consulting Engineers
Date:	October 2008	Mechanical Engineer:	Webston Consulting Engineers
Location:	Juba - South Sudan	Structural Engineer:	Sunya Development
Status:	Completed March 2009	Scope:	Bank Premises Complete with Counters, Banking Hall and Strong room

8.7 Industrial Projects



Project:	Proposed Motor Vehicle Inspection Unit
Client:	GOSS
Value:	US\$ 1,700,000.00 (Approx)
Date:	July 2007
Location:	Juba – South Sudan
Scope:	Inspection Unit with requisite equipment and spaces
Status:	Up to Preliminary Design



Project:	Proposed Industrial Business Park
Client:	Busi Park
Value:	US\$ 1,300,000.00 (Approx)
Date:	June 2008
Location:	Nairobi-Kenya
Scope:	Industrial Area Offices
Status:	Up to Preliminary Design



Project:	Proposed Warehouse
Client:	L. Moss
Value:	US\$ 4,700,000.00 (Approx)
Date:	October 2010
Location:	Juba- South Sudan
Scope:	Supermarket Warehouse
Status:	Up to Preliminary Design

8.8 Health Facilities



Project:	Proposed Extension of Kacyiru Police Hospital
Client:	Rwanda National Police
Value:	US\$ 2,100,000 (Approx)
Date:	November 2011
Location:	Kigali - Rwanda
Scope:	Hospital Offices, Laboratories
Status:	Design and Documentation

Architect:	Landmark Ltd
-------------------	--------------

Quantity Surveyor:	Sunya Development
---------------------------	-------------------

